

Current Rating: 3 Amps
Insulator Resistance: 1000 Megohms min
Dielectric Withstanding: AC 500V
Contact Resistance: 20mΩ MAX
Operation Temperature: -40~+105°C
Max processing temp: 230°C for 60seconds
Max processing temp: 260°C for 10seconds
Contact Material: Brass/Phosphor Bronze
Insulator material: Standard: Polyester, UL 94V-0
Standard: Nylon-6T

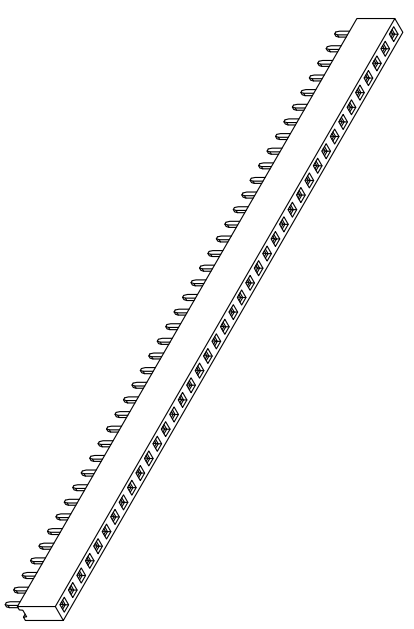

Recommended P.C. Board
SMD Layout

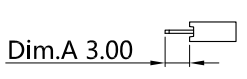
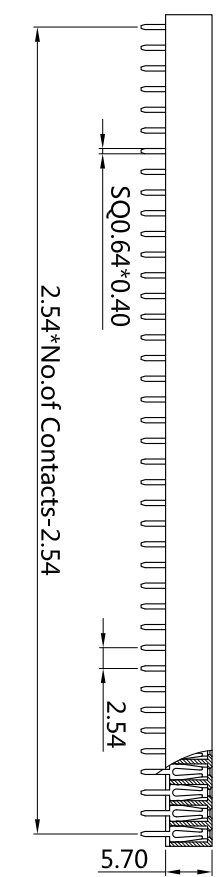
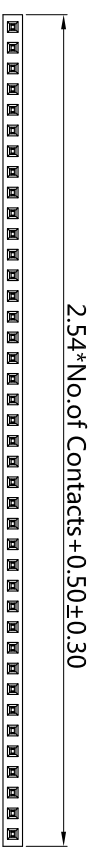
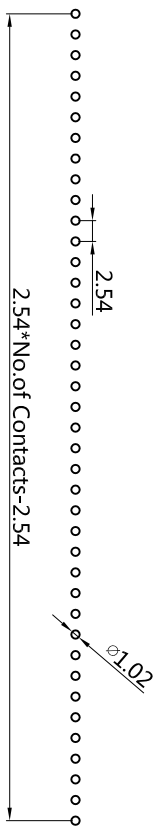

P1 X 57 X - 1 XX S0 BK X 000 X
1 2 3 4 5 6 7 8

1. Insulator material: N=PA6T
2. Contact Plated: T=Matte Tin over Nickel
3. Contact area: W=Matte Tin over nickel 150μ"
4. Tail Style: V=Bright Tin over Nickel
5. Color: C = Putin
6. Contact area: F= Gold Flash, Matte Tin 100μ"
7. Special Options: 8. Packing: B=Tube
8. Packing: C=Tray
9. Packing: D=Small box
10. Packing: E=Cap+Reel
11. Packing: F=Cap+tube
12. Packing: I=Mylar+Reel
13. Packing: H= Contact area 1U", Other areas 0.8U"

		东莞市震升电子有限公司 DONG GUAN ZHEN SHENG ELECTRONICS CO., LTD	
BOM	1:P1N57-140BKHC1	PART NO.	P1X57X-1XXS0BKX000X
	2:P157B-S30-Y00-C11	DRAWING NO	ZS-00103-M
	3:	DRAWN BY	Deng jin quan
		APPROVAL BY	Chen xiao guang
		EDITION:	A1
		SCALE:	1:1
		UNIT:	M:M

1 2 3 4 5 6 7 8

F E D C B A